

Customer Service
1-800-338-9951

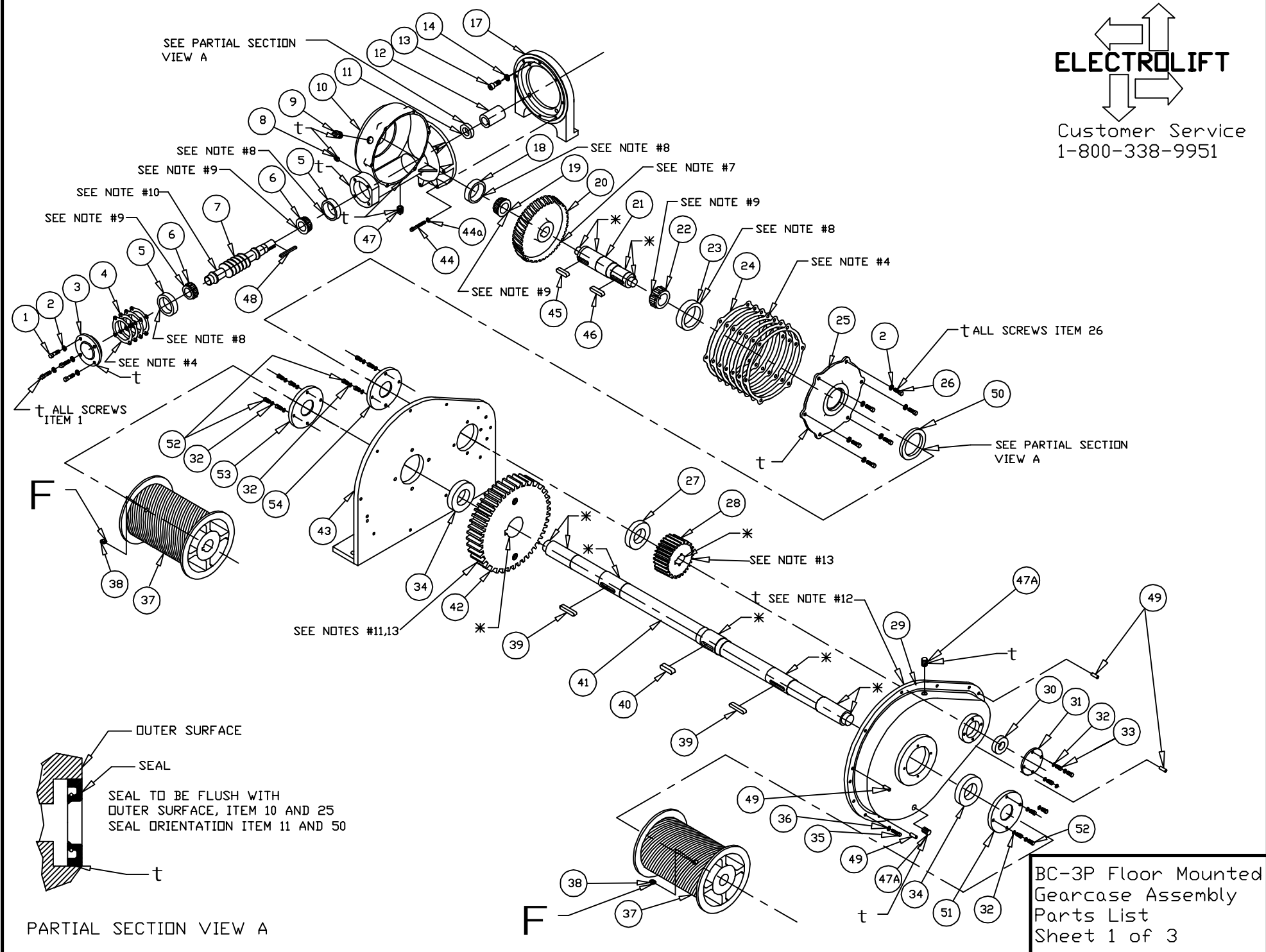

PARTIAL SECTION VIEW A

BC-3P Floor Mounted
Gearcase Assembly
Parts List
Sheet 1 of 3

30	DM7019	1	BEARING, BALL, 6206ZZ, 1.18 ID, 2.44 OD, .62 W ÖSEE NOTE D
29	M1322	1	COVER, SPUR GEAR, BC-3P -- SEE NOTE #14
28	----	1	PINION, JOB SPECIFIC -- SEE NOTE #13
27	DM7018	1	BEARING, BALL, 6211ZZ, 2.16 ID, 3.93 OD, .82 W ÖSEE NOTE D
26	FS129	6	SCREW,HHCS,3/8-16x1 ÖSEE NOTE A
25	M1310A	1	COVER, SIDE, GEAR CASE, BC
24	K10755	1	KIT, SHIM, B-HOIST, SIDE COVER
23	DM7010	1	BEARING, TRB, CUP, 4.25 OD ÖSEE NOTE B
22	DM7009	1	BEARING, TRB, CONE, 2.25 ID ÖSEE NOTE B
21	K1670	1	SHAFT, PINION, BC-3P
20	----	1	WORM WHEEL, JOB SPECIFIC -- SEE NOTE #5
19	DM7003	1	BEARING, TRB, CONE, 1.50 ID ÖSEE NOTE B
18	DM7004	1	BEARING, TRB, CUP 3.00 OD ÖSEE NOTE B
17	M2959	1	ADAPTER, MOTOR, T477, C FACE
16	N/A	-	----
15	N/A	-	----
14	FS320	4	WASHER,INT.TOOTH,1/2,PLATED ÖSEE NOTE A
13	FS207	4	SCREW,SHCS,1/2-13x1-1/4 ÖSEE NOTE A
12	K122P2	1	SLEEVE, MOTOR SHAFT, B HOIST
11	DM7030	1	SEAL, SHAFT, 1.18 ID, 2.06 OD ÖSEE NOTE C
10	T477BC	1	GEAR CASE, BC HOIST
9	FS337	1	PIPEPLUG,1/2 SQHD CORED, W/STRAIGHT VENT ÖSEE NOTE A
8	FS336	1	PIPEPLUG,1/8 SQHD, SOLID ÖSEE NOTE A
7	----	1	WORM SHAFT, JOB SPECIFIC -- SEE NOTE #5
6	DM7005	2	BEARING, TRB, CONE, 1.25 ID ÖSEE NOTE B
5	DM7006	2	BEARING, TRB, CUP, 3.125 OD ÖSEE NOTE B
4	K10756	1	KIT, SHIM, B-HOIST, END COVER
3	K123	1	COVER, END, GEAR CASE, B
2	FS315	10	WASHER,L,3/8 ÖSEE NOTE A
1	FS130	4	SCREW,HHCS,3/8-16x1-1/4 ÖSEE NOTE A
ITEM #	PART #	QTY	DESCRIPTION

*SEE NOTE #14 & KIT NOTES A-E
ON SHEET 3

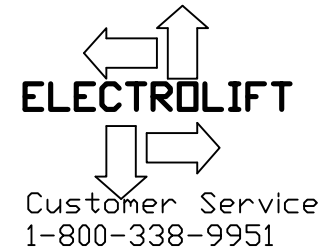

54	K1917AP1	1	COVER, BALL BRG
53	K1917AP2	1	COVER, BALL BRG
52	FS124	12	SCREW,HHCS,5/16-18x1-1/4 ÖSEE NOTE E
51	K1917AP4	1	COVER, BALL BRG
50	DM7031	1	SEAL, SHAFT, 2.25 ID, 3.35 OD ÖSEE NOTE C
49	FS370	2	PIN, ROLL, 1/2x1-1/2 -- SEE NOTE #14
48	K10849P3	1	KEY, 5/16x5/16,2-15/16
47A	FS333	2	PIPEPLUG,1/2 SQHD CORED ÖSEE NOTE E
47	FS333	1	PIPEPLUG,1/2 SQHD CORED ÖSEE NOTE A
46	K10910P2	1	KEY,1/2x1/2x2
45	K10910P4	1	KEY,1/2x1/2x1-15/16
44a	FS312	7	WASHER,L,5/16 ÖSEE NOTE A
44	FS127	7	SCREW,HHCS,5/16-18x2-1/4 ÖSEE NOTE A
43	M2710AP1	1	PLATE, SIDE, BC3P-TH-FLR -- SEE NOTE #14
42	----	1	GEAR, JOB SPECIFIC -- SEE NOTE #13
41	----	1	DRUM SHAFT, JOB SPECIFIC
40	K10910P4	1	KEY, 1/2x1/2x1-15/16
39	K10910P3	2	KEY, 1/2x1/2x2-5/8, DRUM,C,3P-D
38	FS216	2	SOCKET HEAD SET SCREW,1/2-13x1/2,KNURLED
37	----	2	DRUM, JOB SPECIFIC
36	FS315	10	WASHER,L,3/8,PLAIN -- SEE NOTE #14
35	FS131	10	SCREW,HHCS,3/8-16x1-1/2 -- SEE NOTE #14
34	DM7020	2	BEARING, BALL, 6212ZZ, 2.36ID,4.33OD,.86W ÖSEE NOTE D
33	FS123	4	SCREW,HHCS,5/16-18x1 , GR2 ÖSEE NOTE E
32	FS312	16	WASHER,L,5/16, PLAIN ÖSEE NOTE E
31	K900AP30	1	COVER, BALL BRG
ITEM #	PART #	QTY	DESCRIPTION

BC-3P Base Mounted
Gearcase Assembly
Parts List
Sheet 2 of 3

BILL OF MATERIALS

NOTES:

- 1) * - APPLY ANTISEIZE COMPOUND
- 2) † - APPLY PERMATEx ULTRACOPPER SEALANT ELECTROLIFT P/N DM7394
- 3) F - APPLY BLUE TYPE THREADLOCK COMPOUND, TORQUE TO 24 FT-LBS
- 4) USE THE SAME AMOUNT AND COLOR OF SHIMS AS ORIGINAL SET.

5) IDENTIFICATION CHART

NO OF TEETH	WORM WHEEL P/N	WORM SHAFT P/N
36	M336A	M320
41	M12207A	M2851
67	M2864A	M2853

- 6) OIL CAPACITY 18 OZ. EXXON CYLESSTIC TK680 OR EQUIV. E/L P/N DM7146 OR MOBIL SHC 634 OR EQUIV. (SYNTHETIC) E/L P/N DM7381
- 7) PRESS ITEM 20 ONTO ITEM 21 CENTRALLY LOCATED ON ITEM 45
- 8) PRESS ITEM INTO MATING HOUSING OR COVER
- 9) TO BE PRESSED ON MATING SHAFT
- 10) TAP WITH MALLET AFTER PRESSING ITEM 5
- 11) PRESS ITEM 42 ONTO ITEM 41 CENTRALLY LOCATED ON ITEM 40
- 12) COAT ALL TEETH WITH EXXON RONEX MP GREASE P/N DM7154
ITEM 29 IS TO BE AT APPROX. 50% CAPACITY FULL OF GREASE WHEN SEALED.
COAT MATING SURFACES ON ITEM #43 & ITEM #29
WITH PERMATEx ULTRACOPPER SEALANT ELECTROLIFT P/N DM7394

13) IDENTIFICATION CHART

PINION- THE SMALLER OF THE TWO GEARS
GEAR- THE LARGER GEAR
PINIONS AND GEARS ARE MATCHED SETS AS KITS

KIT	# TEETH	PINION P/N	# TEETH	GEAR P/N
K11201P1	12	K1636P10	51	K1636P2
K11201P2	13	K1636P3	50	K1636P4
K11201P3	14	K1636P16	49	K1636P17
K11201P4	15	K1636P12	48	K1636P13
K11201P5	16	K1636P14	47	K1636P15
K11201P6	17	K1636P28	46	K1636P29
K11201P7	18	K1636P24	45	K1636P9
K11201P8	19	K1636AP30	44	K1636AP31
K11201P9	20	K1636P25	43	K1636P26
K11201P10	21	K1636P19	42	K1636AP36

- 14) M1322 & M2710P1 ARE NOT AVAILABLE INDIVIDUALLY.
THEY ARE AVAILABLE ONLY AS MATCHED SET M12275,
ALONG WITH NOTED HARDWARE.

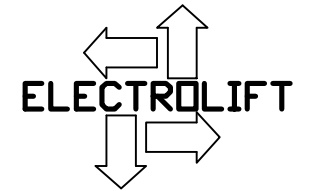

Customer Service
1-800-338-9951

○ KIT NOTES:

- A) THIS PART CAN ONLY BE ORDERED AS PART OF GEARCASE HARDWARE KIT #K11236.
- B) THIS PART CAN ONLY BE ORDERED AS PART OF GEARCASE BEARING KIT #K11158.
- C) THIS PART CAN ONLY BE ORDERED AS PART OF SEAL KIT #K11159.
- D) THIS PART CAN ONLY BE ORDERED AS PART OF SPUR GEARBOX BEARING KIT #K11161.
- E) THIS PART CAN ONLY BE ORDERED AS PART OF SPUR GEARBOX HARDWARE KIT #K11237.
- F) FOR BOTH SEALS & SHIMS, ORDER SEAL & SHIM KIT #K11282.

BC-3P Floor Mounted
Gearcase Assembly
Parts List
Sheet 3 of 3