

SEE NOTE #2

\*ALLOW 6" CLEARANCE TO SERVICE BRAKE

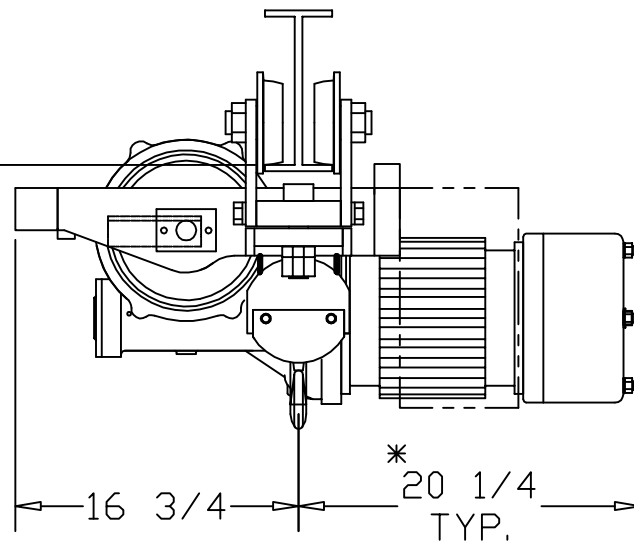

CUSTOMER:

ELECTROLIFT AUTHORIZED DISTRIBUTOR:

REFERENCE NO.:

		CATALOG #	
		LH100-PL	-
SPEED (FPM):	25	-	-
LIFT (FT):	15	-	-
CAPACITY (LBS):	3000 LBS		
REEVING:	2 PART DOUBLE		
PRIMARY VOLTAGE:	460 or 230 (3 PH. STD)		
CONTROL VOLTAGE:	115 (STD)		
HOIST WEIGHT (LBS):	530		
HP:	4		
WHEEL LOADINGS (LBS PER WHEEL PAIR):			
FULL UP		FULL DOWN	
LEFT SIDE	RIGHT SIDE	LEFT SIDE	RIGHT SIDE
1582	1948	1582	1948
HOOKBLOCK DRIFT AT FULL DOWN POSITION (IN.) (X):		NONE	
HOIST NOTES:			
1. LARGER CONTROL BOXES MAY NEED TO BE RELOCATED			
2. TRACK WIDTH NOT TO EXCEED 4"			
		ELECTROLIFT, INC. 204 SARGEANT AVE. CLIFTON, NJ 07013 PH: 973-471-0204 FAX: 973-471-2814 www.electrolift.com	
REV.	ECO#	DATE	BY:
HOIST TYPE: "B" SINGLE HOOK			
CONFIGURATION: PLAIN TROLLEY			
DATE:	SCALE:	DWG SIZE:	DRAWN BY:
9/17/08	1:12	B	AR
CATALOG NO.: LH100-PL		DRAWING NO.: B-178	